

2.2 External Ceiling System

System Reference (EC1GM13)

SYSTEM COMPONENTS		DETAILS
1	13 mm Gypsemna Glassmat Board	Board on Bottom
2	Main Channel 38 x 12 x 12 , 0.60mm <i>as Main Runner</i>	800 mm max centers
3	Furring Channel 64 x 35 x 23, 0.60 mm <i>as Cross Runner</i>	400 mm max centers
4	GI L-Angle 25 x 25, 0.60 mm <i>as Suspension</i>	800 mm max centers
5	GI L-Angle 25 x 25, 0.60 mm	as perimeter angle
6	Wedge Anchor - 6 x 40 mm	as suspension anchor
7	Hammer Screw, Size: 6 x 40 mm <i>Wall Angle Fixing</i>	600 mm max centers
8	Waferhead Screw M4.2 x 13 mm	Metal to Metal Fixing
9	Self Tapping Screw M3.5 x 25 mm	Boards to Metal Fixing
10	Jointing Tape - Fibre	For Joint Finishing
11	Jointing Compound - Exterior	For Joint Finishing

External Ceiling

« Single Layer of 13 GM Concealed Ceiling with Suspension Rigid System »

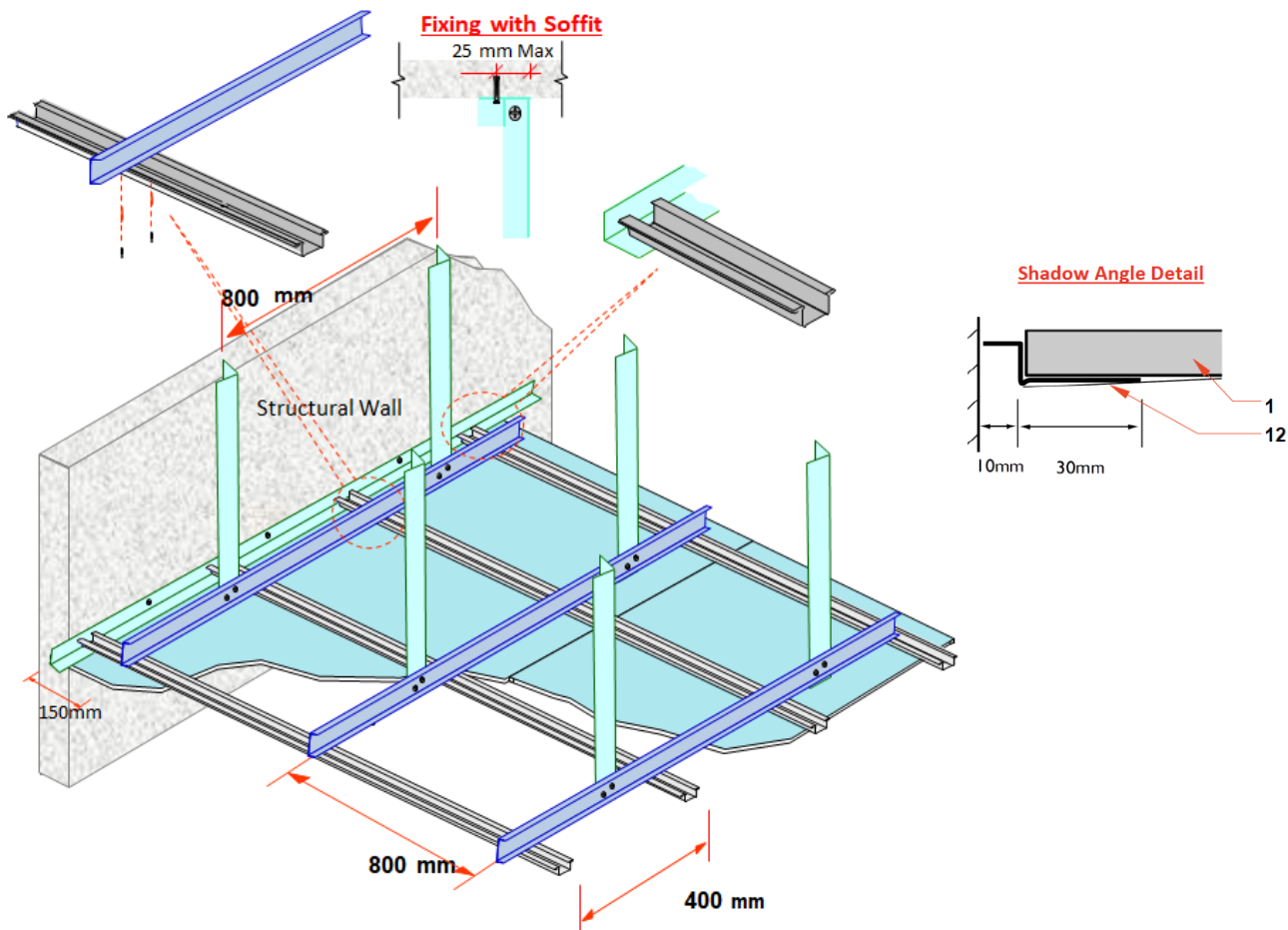

Note: Maximum centers for ceiling cross runners, main runners, hangers, and brackets are based on limiting deflection criteria of L/360, allowing for loading of plasterboard and insulation as shown in the performance tables. If an additional load will be applied to the ceiling, contact the Gypsemna Technical team. Performance values are for imperforate, jointed systems using only Gypsemna components and installed to the Gypsemna specification given. Any alterations may well impair the quoted performance criteria.

www.gypsemna.com