

2.3 Grid Ceiling System

System Reference (CTRG70,CTRG90,CTRG120)

SYSTEM COMPONENTS		DETAILS
1	Gypsemna Gypsum Ceiling Tile 595 x 595 x 9 mm	Tile on Bottom
2	Gypsemna T24 Main Tee - 38 x 24 x 3600 mm	1200 mm max centers
3	Gypsemna T24 Cross Tee - 26 x 24 x 1200 mm	600 mm max centers
4	Gypsemna T24 Cross Tee - 26 x 24 x 600 mm	1200 mm max centers
5	Gypsemna T24 Perimeter Angle - 24 x 24 x 3000 mm	
6	Double Spring Clip - 4 mm	
7	4 mm Wire Rod - 40 m	
8	6 x 60 mm Ceiling Anchor with Eye Hole	

TILE

« Single Layer 9 mm RG Concealed Ceiling with Wire & Clip Suspension - Rigid System »

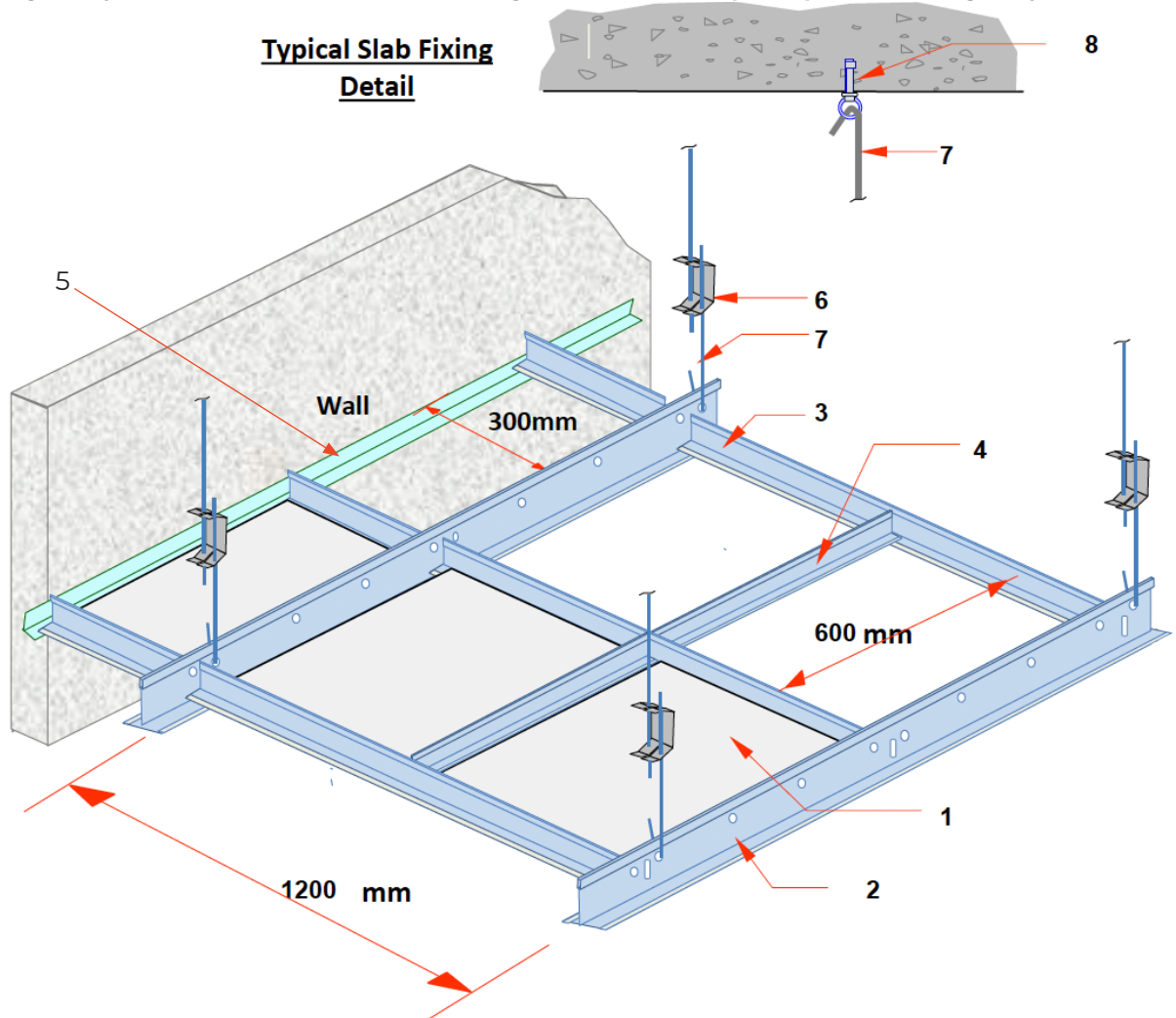

Note: Maximum centers for ceiling cross runners, main runners, hangers, and brackets are based on limiting deflection criteria of L/360, allowing for loading of plasterboard and insulation as shown in the performance tables. If an additional load will be applied to the ceiling, contact the Gypsemna Technical team. Performance values are for imperforate, jointed systems using only Gypsemna components and installed to the Gypsemna specification given. Any alterations may well impair the quoted performance criteria.